

RYCO FILTERS



FITTING INSTRUCTIONS FOR RYCO CABIN FILTER RCA164P.

TOYOTA TARAGO

(Filter is located behind glove box)

- 1** The cabin air filter is located behind the glove compartment.

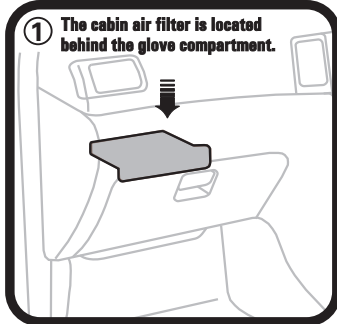

- 4** To remove filter assembly, push on both ends of the cover as shown and pull out.

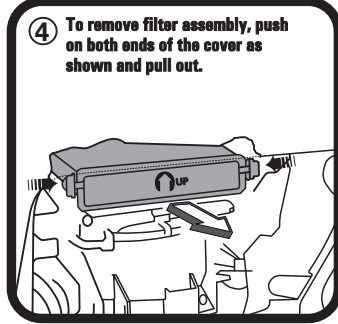

- 2** Open the glove compartment & remove the support arm by sliding arm of the pin.

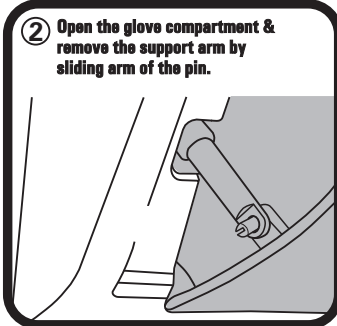

- 5** Noting flow direction remove old filter, insert new filter (Note flow direction) then refit all previously removed parts.



- 3** Apply pressure to the front and rear of glove compartment as shown to disengage the claws, open all the way.

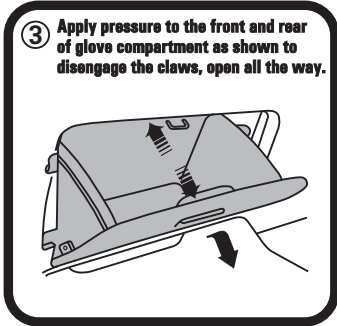

6

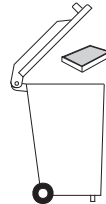

Dispose of used filter correctly.

GUD Automotive Pty Ltd
245 Sunshine Road Tottenham
Victoria 3012 Australia.
www.rycofilters.com.au

GUD (NZ) Ltd
626A Rosebank Road Avondale
Auckland, New Zealand
www.ryco.co.nz